

GENERAL TOLERANCE ±0.1mm UNLESS SPECIFIED

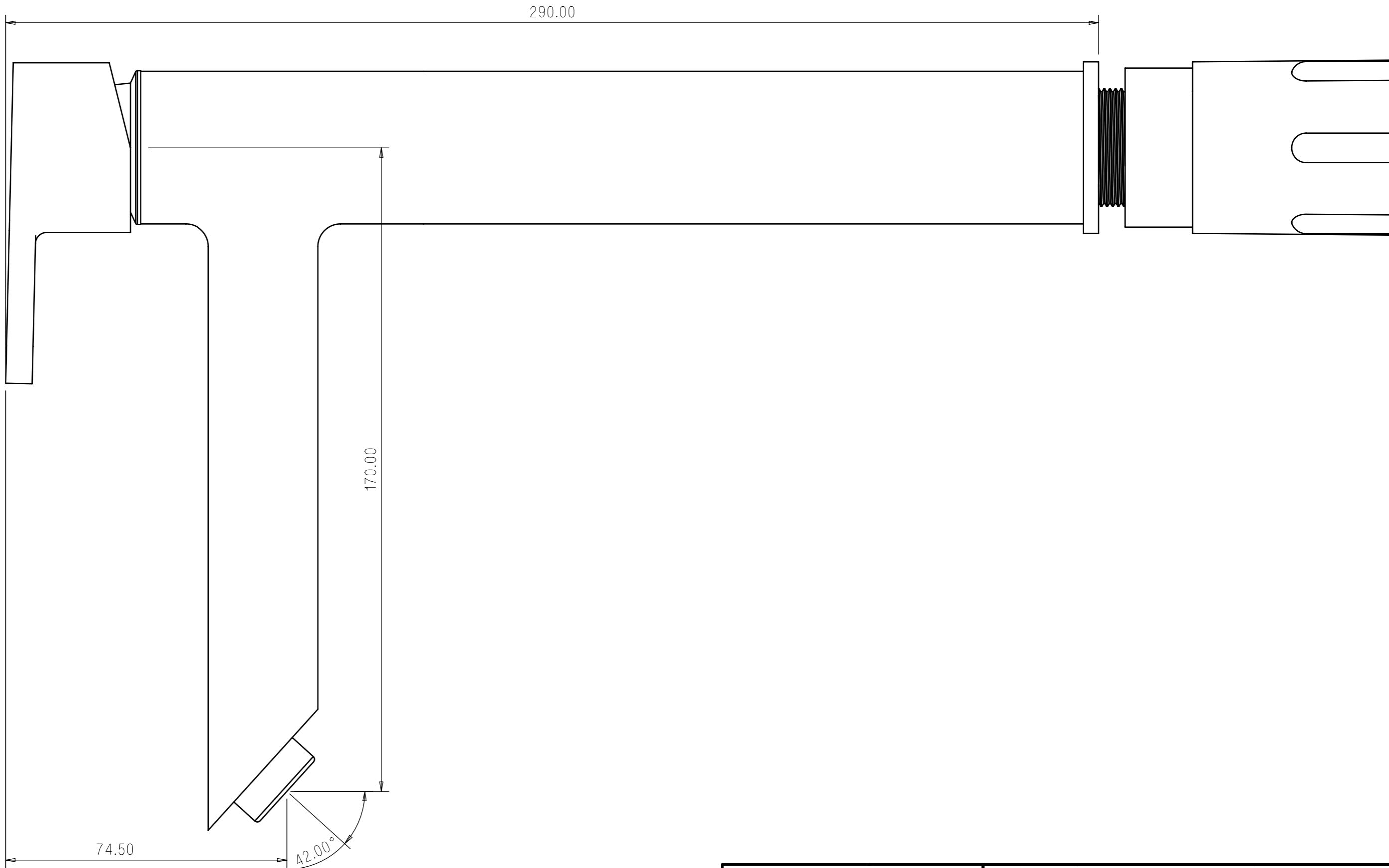

| Flow Rate in LPM at | | | |
|---------------------|---------|---------|---------|
| 0.5 BAR | 1.0 BAR | 2.0 BAR | 3.0 BAR |
| | | | |

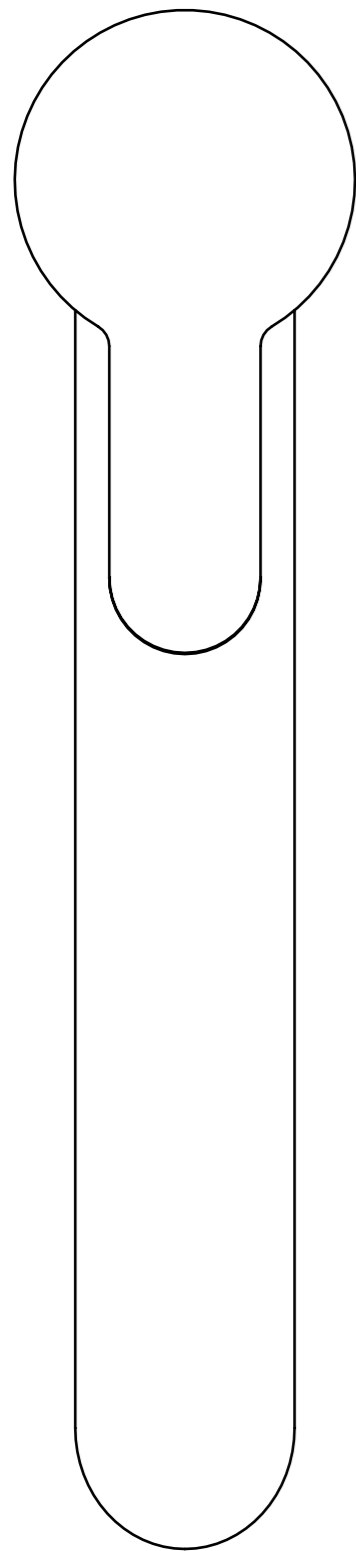
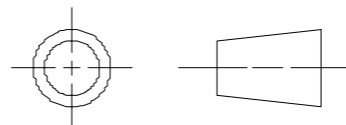

ALL DIMENSIONS IN MM

SCALE -1:1

BATH ASSETS & SINKS
prayag
 TOUCHING LIFE. EVERYDAY

DRAWN BY:

CHECKED BY:

TYPE:

PRAYAG POLYMERS (P) LTD.
 A-1129, Phase-III, RIICO Indl.Area, Bhiwadi(Raj.)

TITLE:

SIZE: 297.0 x 480.0

PART NAME-

DATE:

CAT NO 7852

MATERIAL:

WEIGHT:

297.0 x 480.0